



AXXA

The Power
Behind Production

www.axxacnc.com



About Us

Axxa are leading provider of automation products & solutions. Our reputation for customer satisfaction, ethical business philosophy and superior technical ability ensures that our loyal client base continues to grow.

Axxa hold over 5 million pounds worth of stock here in the UK, which is continuing to grow and is all available to be collected or delivered same day within the UK. Overseas delivery usually will take 1-3 working days.

Full Project Management



Specification



Supply



Installation



Commisioning



CONTROL
TECHNIQUES

LEROY
SOMER

Honeywel

CAMOZZI

DATALOGIC

MECHAN
CONTROLS

EUROPA

EMAS



FE
Fuji Electric

UNIVERSAL
MOTORS

Brands we support...

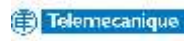

Low Voltage Motor Controls

From urgent 'machine down' situations to routine maintenance, our highly technical team is here to help.

- ✘ Contactors (Stocked upto 450kW)
- ✘ Overload Relays
- ✘ Safety Relays
- ✘ Switches

And much more...

Call us today to discuss your individual automation requirements

+44(0)1782 497000

sales@axxacnc.com



Pressure switches



Axxa can not only supply these products at a fantastic price but we can also offer a precise setting service using our in house calibration equipment. The railway sector greatly benefits from this as we have already dealt with many companies within this industry!



Variable Frequency Drives

Lifting, crushing, cooling, pumping, mixing. Nowadays that motor should probably be controlled by a Variable Frequency Drive (ask us about upgrading from direct on line). As part of our superior product offering, we chose to distribute Control Techniques. Designed and manufactured in the UK, providing an industry beating 5 Year Warranty, Control Techniques have been the industry leader in motor control since 1973. Control Techniques aligns perfectly with the Axxa brand ethos; recognised for ease of system build, commissioning, and maintenance.

Get in touch to arrange a consultation or site visit.

+44(0)1782 497000

sales@axxacnc.com



Official Distributor



AC Induction Motors

At the centre of industry is the induction motor.

There is always one spinning away either behind the scenes or in broad daylight.

All motors we supply are premium and a minimum of IE3 plus efficient.

With competitive prices, warranty & quick turn around it's an easy choice to partner up with us.

- ✘ Single or 3 Phase
- ✘ Aluminium or Cast Iron
- ✘ Braked
- ✘ Geared
- ✘ Forced Ventilation
- ✘ ATEX Environments
- ✘ Integrated drive motors
- ✘ Specials

Contact us today for more information.

+44(0)1782 497000

sales@axxacnc.com



Drive Panel Building Service

Offering an extensive range of pre-built 'plug and play' VFD panels, including heavy duty capability, up to 110kW, our precision engineered units are suitable for every application. Whatever your focus is from improving efficiency, greater operational control or less line disturbances to reducing maintenance or a longer motor life, we will work with you to offer the right solution for all your panel needs. We also hold a full stock of spares for maintenance or backup use. As part of our custom-build service we offer full project management to see your specification through from concept to completion. Our team is highly experienced in control application for a huge variety of functions including; pneumatics, remote control, temperature control, stainless steel panels, pumps, fans, compressors, PLCs, conveyors and much more.

All of our control panels are supplied with a warranty which is based on the applications requirements used.



Machine guarding

Mechan Controls which are designed and manufactured here in the UK. Axxa is your one stop safety shop for all safety requirements.

- ✘ Radio frequency identification technology (RFID) with up to 4 million unique codes.
- ✘ Magnetic Safety switches
- ✘ Light curtains
- ✘ Safety Relays
- ✘ Solenoid interlock switch's

Ask us for a demonstration of these products!



Visit our Sister Company

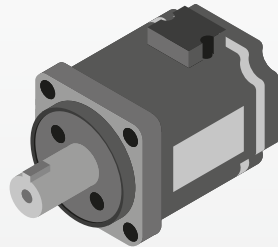

SERVO MOTORS

www.servouk.com

